

## Distribution Block

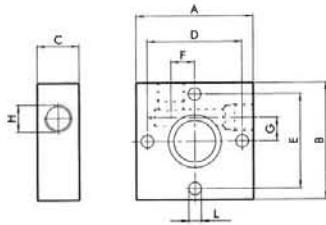

Order Code	Description	€
9200401	G1/8 for G1/4 Units	16.86
9400401	G1/4 for G3/8 - G1/2 Units	25.31
9600401	G1/2 for G3/4 - G1 Units	49.20

The air take-off has the job to take off the air from the FRL unit irrespective of the position where it is assembled. It is required whenever you need to take off air from the FRL unit at different stages of the treatment (normal, filtered, filtered regulated, lubricated, etc.)

### Technical Data

Threaded Port  
Max. Working Temperature at 10 bar  
Max. Admissible Pressure

9200401	9400401	9600401
G1/8"	G1/4"	G1/2"
50 °C	50 °C	50 °C
18 bar	18 bar	18 bar

	A	B	C	D	E	F	G	H(n°2pos.)	L
G 1/4"	42	42	15	34	34	8.5	8.5	21	M4 Hole
G 3/8"	60	60	20	49	49	14	14	30	M4 Hole
G 1/2"	60	60	20	49	49	14	14	30	M4 Hole
G 3/4"	80	80	30	64	64	16	16	40	M6 Hole
G 1"	80	80	30	64	64	16	16	40	M6 Hole

## Manifold Block

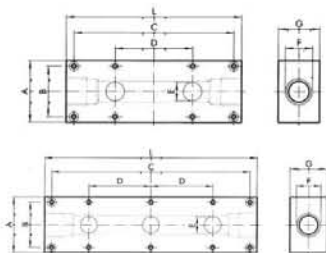

Order Code	Description	€
9200201	G1/4 Regulator 2 position	50.68
9200301	G1/4 Regulator 3 position	61.91
9400201	G1/2 Regulator 2 position	74.56
9400301	G1/2 Regulator 3 position	92.99

With the Newdeal sub-base, more than one regulator can be mounted in parallel using a single pressure supply source.

Dimensions	ND 1/4"		ND 3/8"-1/2"		ND 3/4"-1"	
	2 position	3 position	2 position	3 position	2 position	3 position
A	50	50	60	60	80	80
B	43	34	49	49	64	64
C	113	165	155	230	190	280
D	52	52	75	75	90	90
E	G1/4	G1/4	18	18	31	31
F	G1/2	G1/2	G3/4	G3/4	G1"1/4	G1"1/4
G	30	30	40	40	50	50
L	128	180	170	245	210	300

## Drip Leg Drain

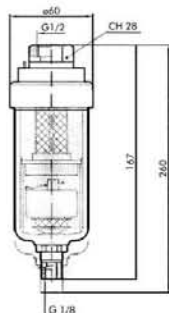

Order Code	Description	€
4589003	G1/2 Port	66.83

### Technical Data

Threaded Port \_\_\_\_\_ G1/2"  
Max. Working Temperature at 10 bar \_\_\_\_\_ 50 °C  
Max. Admissible Pressure \_\_\_\_\_ 18 bar

Wall Fixing Screws \_\_\_\_\_ M6x75

System supply condensate drain:

- All-round condensate level viewing
- Automatic drain from inside the bowl
- Axial coupling

## Mounting Hardware

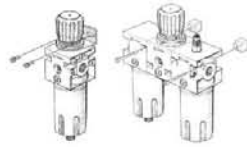

P11

Order Code	Description	Size	€
9200701	Mounting Bracket	G1/4	3.36
9400701	for Regulator	G3/8 - G1/2	4.56
9200601	Spacer for	G1/4	5.65
9400601	Wall Mounting	G3/8 - G1/2	6.19
9600601	FRL	G3/4	11.25

## Spring



P11

Order Code	Description	€
9250601	G1/4 to 0-2 bar	3.37
9250602	G1/4 to 0-4 bar	3.37
9250603	G1/4 to 0-8 bar	3.37
9250604	G1/4 to 0-12 bar	3.37
9450601	G3/8 - G1/2 to 0-4 bar	4.25
9450602	G3/8 - G1/2 to 0-8 bar	4.25
9450603	G3/8 - G1/2 to 0-12 bar	4.25
9650601	G3/4 - G1 to 0-4 bar	8.46
9650602	G3/4 - G1 to 0-8 bar	8.46
9650603	G3/4 - G1 to 0-12 bar	8.46

## Spare Filter Element



P11

Order Code	Description	€
9250103	4 Micron for Filter G1/4	9.45
9250102	20 Micron for Filter G1/4	9.45
9450103	4 Micron for Filter G3/8 - G1/2	12.31
9450102	20 Micron for Filter G3/8 - G1/2	12.31
9650103	4 Micron for Filter G3/4 - G1	17.19
9650102	4 Micron for Filter G3/4 - G1	17.19
9450105	Coalescing Oil Removal Filter	43.14

## Shut-Off Valve Adaptor



P11

Order Code	Description	€
9201001	for Shut-Off Valve G1/4	0.80
9401001	for Shut-Off Valve G1/4	0.87
9401002	for Shut-Off Valve G1/4	0.94

## Pressure Gauges



S15

Order Code	Description	Size	€
PGR050418	50mm 0-4bar	G1/8	8.45
PGR051018	50mm 0-10bar	G1/8	8.45
PGR050414	50mm 0-4bar	G1/4	8.45
PGR051014	50mm 0-10bar	G1/4	8.45

## Automatic Drain



P11

Order Code	Description	Size	€
9000801	Fully Automatic	G3/8 - G1	33.96
9000803	Semi Automatic	G1/4 - G1/2	14.51
9255201	Metal Bowl for use	G1/4	23.96
9455201	with Semi Automatic Drain	G3/8 - G1/2	29.72

## Assembly Kit



P11

Order Code	Description	Size	€
9200901	Tie Rods	G1/4	3.72
9400901	Filter + Lub.	G3/8 - G1/2	4.23
9600901	for G1/4	G3/4 - G1	5.65
9250001	Assembly Screws for	G1/4	1.73
9250002		G1/4	1.73
9450001		G3/8 - G1/2	1.40
9450002		G3/8 - G1/2	0.76
9450003		G3/8 - G1/2	3.05
9650001		G3/4 - G1	1.96

## Spare Bowl



P11

Order Code	Description	€
9250301	for G1/4 Filter	14.88
9255201	for G1/4 Filter with Autodrain	23.96
9450301	for G3/8-G1/2 Filter	20.50
9455201	for G3/8-G1/2 Filter with Autodrain	29.72
9650301	for G3/4-G1 Filter	44.38
9251201	for G1/4	14.01
9451201	for G3/8-G1/2	18.27
9651201	for G3/4-G1	40.85

COUPLINGS

HYDRAULICS

PNEUMATICS

BOSCH  
REXROTH  
PNEUMATICS

AIR  
TREATMENT

TUBE  
FITTINGS

HOSETAILS &  
ADAPTORS

STAINLESS  
STEEL

VALVES

TUBING &  
HOSECLIPS

HOSE REELS,  
PUMPS &  
GARAGE  
EQUIPMENT

AIR, WATER  
& PAINT  
GUNS

VACUUM  
EQUIPMENT

COMPRESSED  
AIR SYSTEMS

MALLEABLE  
IRON

TOOLS &  
MEASURING

AIR TOOLS  
COMPRESSORS

ENGINEERING  
MAINTENANCE

PARTS  
HANDLING  
& STORAGE

ALUMINIUM  
PROFILE &  
ACCESSORIES

SPILL  
CONTROL